

ALE HOP

TECH & HOSPITALITY RIDER

All questions to be directed to: [mo\[at\]media-loca.com](mailto:mo[at]media-loca.com)

RIDER

PA

The artist needs a PA system and a sound engineer.

MONITORING

Monitors, with suitable amplification

EQUIPMENT

The promoter needs to provide the following technical equipment:

- 2 x Active DI Boxes (for a Computer)
- 1 x Guitar Amplifier - Preferably Fender Twin (should be miced)
- 1 x Bass Amplifier - Ampeg 810 - Any other Ampeg model (Preferably use a bass drum microphone)
- 1 x Microphone Stand
- 1 x Multiplugs x 220 Volts w/ European input plug
- 1 x Microphone for voice (processed into the Computer)
- 2 mini tables (see STAGEPLOT, pag. 2)

The artist will bring with her:

- 1 x Computer
- 1 x Soundcard
- 1 x Electric Guitar
- Pedals
- Contact Microphone w/ pre amp

SOUNDCHECK

The artist needs 40 minutes for soundcheck.

She uses 4 channels in the main mix:

Line 1/2 Computer

Is a mix of electronic beats, atmospheres and her processed voice. Has frequencies all over the spectrum, it should not be lowcut, nor highcut. Usually she needs to cut frequencies from her voice directly in her computer to avoid feedback from the microphone.

Line 3 The bass amp should push sub bass and low frequency in the PA (it should feel like a strike of sound hitting the audience).

Line 4 The guitar amp should focus on low mid and bass.

STAGEPLOT

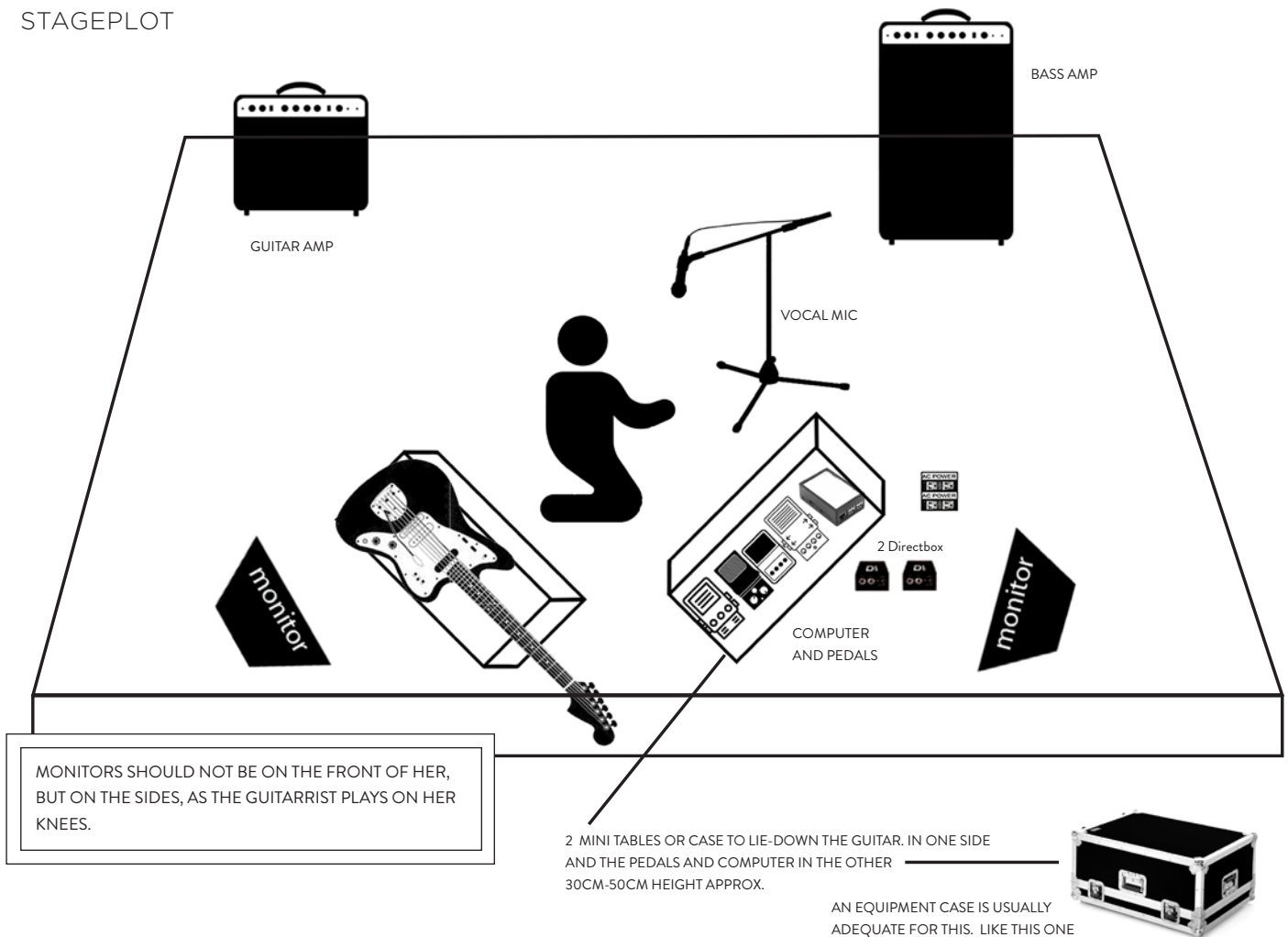

LIGHTING/AV

The show has a video. The artist will bring a **USB stick with an mp4 video (1920 x 1080 px)** file to be reproduced from a computer or a video mixing console available. In case there is no device available to reproduce the file please notified with reasonable time prior so the artist can plan to bring an extra computer or device to reproduce the file.

Lights should be focused and pointing on what she is doing on stage, avoid ambient light washing out the image on the projection.

CATERING & HOSPITALITY

A private, secure area safe enough to store equipment.

Refreshments:

- Water
- Red Bull, or coffee
- Non-alcoholic beer

(No dietary or food restrictions.)

FLYING TRAVELING SPECS

1 hand baggage item: carry-on 10 kg (50 x 40 x 20 cm) - normally goes in the plane as hand luggage. (In Ryanair it is only allowed the 10kg carry-on on the plane with "priority boarding".)

1 check-in baggage item: (15 kg) for the electric guitar that goes in a hardcase. (In Ryanair it needs to be specially bought as "instrument" baggage.)

SHOW INFO

Title of the show: 'Ale Hop, Live A/V'

Duration: 40 minutes

PROMO

PHOTOS

<https://www.dropbox.com/sh/k7e99mxpssje2t9/AAAXvXMJpC57DF76PaB0hMa3a?dl=0>

AUDIO

<https://soundcloud.com/alehophop2/sets/apopenia>

VIDEO

<https://youtu.be/37KiPjlfxn4>

SOCIAL MEDIA HANDLES

Facebook @alehophop

Instagram @ale_hophop

Twitter @alehophop